



University of  
Nottingham

UK | CHINA | MALAYSIA

# University of Nottingham Ningbo China

**Facts Sheet 19/20**



[international@nottingham.edu.cn](mailto:international@nottingham.edu.cn)

# About UNNC

University of Nottingham UK opened its China campus in 2004, becoming the first Sino-foreign University approved by the Ministry of Education in the People's Republic of China. University of Nottingham Ningbo China (UNNC) offers the best of both worlds – you will have the opportunity to live in China, while studying at a campus where the first language is English.

UNNC mission statement is "Academic Excellence in the Service of Global Citizenship". All undergraduate and postgraduate programmes in Ningbo are conducted entirely in English with the same teaching and evaluation standards as at Nottingham UK by staff either seconded from Nottingham UK or appointed internationally to University of Nottingham standards.

The University is located in Ningbo Higher Education Park on a newly built and dedicated campus with a land area of 114 acre (584,666 square meter). It currently has around 8,000 undergraduate and postgraduate students and more than 900 teaching and administrative staff from over 40 countries in the world.



Free **Chinese language** lessons and full range of **Sports Facilities** on campus open to all students

International students from over **70** countries take over **13%** of the total

The TEF Panel judged that the University of Nottingham delivers consistently outstanding teaching, learning and outcomes for its students



**100%** study programmes delivered in English



Ningbo city was Ranked in **Forbes** List of the Top Cities for business In China



Ranked **Top 100** of universities worldwide

-QS World University Rankings 2020



Over **100 Student Societies** and a range of **Voluntary and Cultural Activities** to enrich extracurricular life



## Key Facts



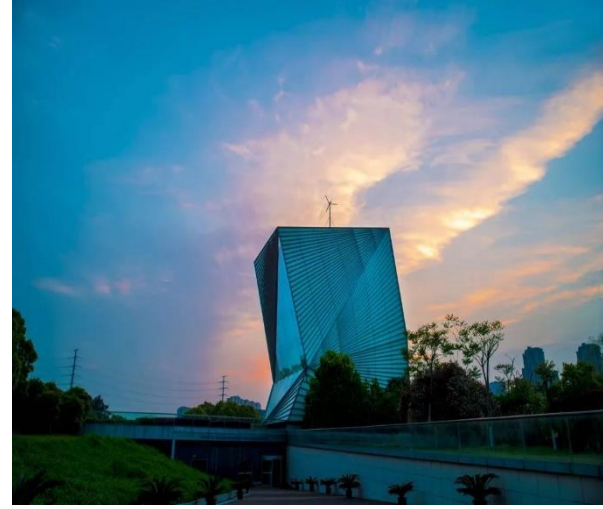

# Undergraduate Courses

## Faculty of Business

- International Business Management
- Finance Accounting and Management
- International Business Economics
- International Business with Language
- International Business with Communications Studies

## Faculty of Humanities and Social Sciences

- International Economics and Trade
- Economics
- International Studies
- International Studies with Language
- International Communications Studies
- International Communications Studies with Chinese
- English Language and Applied Linguistics
- English Language and Literature
- English with International Business

## Faculty of Science and Engineering

- Architectural Environmental Engineering

- Architecture
- Aerospace Engineering
- Chemical Engineering
- Civil Engineering
- Environmental Engineering
- Electrical and Electronic Engineering
- Mechanical Engineering
- Product Design and Manufacture
- Environmental Science
- Computer Science
- Computer Science with Artificial Intelligence
- Mathematics with Applied Mathematics
- Chemistry
- Statistics

## Language Centre

- French
- German
- Japanese
- Mandarin
- Spanish







# Postgraduate Courses

## Faculty of Business

- MSc Entrepreneurship and Innovation Management
- MSc Finance and Investment
- MSc International Business
- MSc International Management
- MSc Professional Accounting

## Faculty of Humanities and Social Sciences

- MA International Higher Education
- MA Teaching English to Speakers of Other Languages (TESOL)
- MA Applied Linguistics
- MA International Communications Studies
- MA Interpreting and Translation, Mandarin and English
- MA International Relations and World History
- MA International Relations and International Business

## Faculty of Science and Engineering

- MSc Geospatial Engineering with BIM







## Course Information

### Credit and Course Load

Students are required to undertake a full time course of study for one or two semesters. Modules are normally worth 10-20 credits each. The average full time workload is 60 Nottingham credits (30 ECTS credits) in one semester and 120 credits (60 ECTS credits) over two semesters in one year. 50 credits is the minimum full-time workload in one semester. All courses are conducted in English.

### Area of Study

UNNC offers a wide range of subjects for your period of study abroad, including Business, International Communications, International Studies, Economics, Science and Engineering, English at different level including UG and PG. For more detail please visit our website:

<http://www.nottingham.edu.cn/en/faculties/index.aspx>

### Academic Calendar

Autumn Semester: September – January  
Spring Semester: February - June  
Full Academic Year: September –June  
<https://www.nottingham.edu.cn/en/about/kev-dates/home.aspx>

### More about Scholarship

<https://www.nottingham.edu.cn/en/global/degree-programme/scholarship-financial-aid/nondegree.aspx>

## Scholarships

### UNNC Mobility Scholarship

Up to RMB 650,000 (USD 100,000) scholarship available to 50% incoming students.

Eligibility: Candidates must be from outside of mainland China (including Hong Kong, Macao and Taiwan); Candidates should be nominated by home institutions/agent.

### Ningbo Government Scholarship

RMB 6,000 (USD 900) each per academic year available to 5% incoming students.

Eligibility: Candidates must be a foreign citizen. (except Hong Kong, Macao and Taiwan); Candidates should demonstrate high levels of academic performance; Candidates should apply from Global Engagement Office of UNNC.

### Scholarship for Students from Hong Kong, Macao and Taiwan

RMB 6,000 (USD 900) each available to 70% incoming students.

Eligibility: Be a HMT applicant who submit the application; Merit-based selection based on outstanding academic achievement.

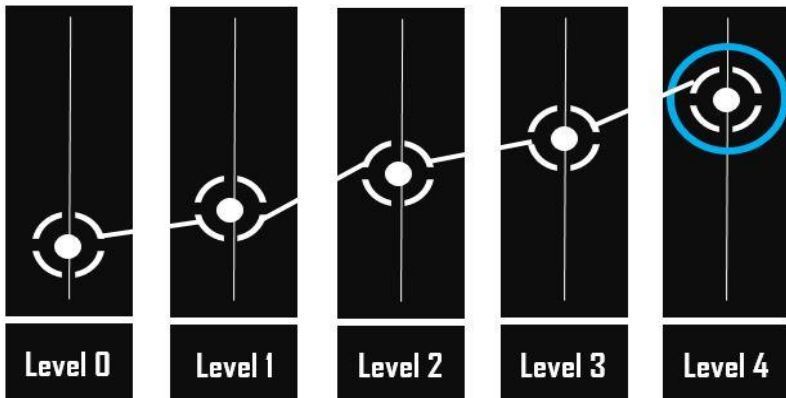

## Selecting Modules

Students should choose modules at the appropriate Level (Year) for their own degree program. For module details, please refer to module catalogue:

[https://campus.nottingham.ac.uk/psp/csprd\\_pub/EMPLOYEE/H RMS/c/UN\\_PROG\\_AND\\_MOD\\_EXTRACT.UN\\_PAM\\_CRSE\\_EXTR CT.GBL?](https://campus.nottingham.ac.uk/psp/csprd_pub/EMPLOYEE/H RMS/c/UN_PROG_AND_MOD_EXTRACT.UN_PAM_CRSE_EXTR CT.GBL?)

(The third character of the module code indicates the module level)

### Level 0

For UNNC Undergraduate Year 1 students  
Example: H10FM1 Foundation Mechanics

### Level 1

For UNNC Undergraduate Year 2 students (UK Year 1 students)  
Example: CS1811 Japanese 1A

### Level 2

For UNNC Undergraduate Year 3 students (UK Year 2 students)  
Example: P12406 Quantitative Methods 2A

### Level 3

For UNNC Undergraduate Year 4 students (UK Year 3 students)  
Example: AS3001 China and the World

### Level 4

For UNNC Postgraduate students  
Example: ES4141 World English: East and South-East Asia



# Entry Requirement

All applicants must be a current student at an overseas university or college of higher education and have completed at least one year of study at their home institution. Students apply for International Exchange program must be nominated by their home university.

Applicants from non-English speaking countries must submit evidence of English language proficiency at the time of application.

## English Requirement

- IELTS 6.5 with the writing band no less than 6.0 or
- TOEFL (paper based) 575 + TWE no less than 4.5 or
- TOEFL (computer based) 232 + TWE no less than 4.5 or
- TOEFL (IBT) 88 (minimum 19 in any element) or
- have passed 60 ECTS (European Credits) in English-taught courses
- English Proficiency letter issued by home institution



## How to Apply

Once we receive nomination from partner, students will receive an automatic email send from our IOMS (online system) with your username and password for online application (<http://ioms.nottingham.edu.cn>)

Students will then need to fill in online form and upload relevant supporting documents including:

- Your most recent academic transcript
- copy of your passport
- passport size photo
- copy of your English language test result (if applicable)

Once we receive student's online application, it may take at least 2-3 weeks for UNNC school approval. Student will receive an automatic email once your application has been approved and you can proceed to next steps including accommodation application, payment of fees etc.

## Application Deadline

- 1<sup>st</sup> May for September Entry
- 30<sup>th</sup> October for January/February Entry



# Living Cost

The cost of living in Ningbo is much cheaper than in many cities in the world. The cost of living in Ningbo for a single international student is estimated at 2,750-4,300RMB (400-630 USD) per month including accommodation, meals, entertainment and other necessities depending on life style.

Electricity/water/phone	150-200 RMB
Book	200 RMB
Food	600-1,500 RMB
Accommodation	900-1,300 RMB
Entertainment/Others	800-1,000 RMB
Public Transportation	100 RMB
Total	2,750-4,300 RMB



# Insurance

All international students must be covered by 'Comprehensive International Student Insurance of China Pacific Insurance (Group) Co., Ltd (CPIC) for his/her whole study period. CPIC shall undertake the following insurance liabilities during the period of insurance: death insurance, accidental disability insurance, medical insurance for accidental injury, outpatient, emergency and hospitalization. This insurance costs 800 RMB for a year or 400 RMB for six months. One year postgraduate students are required to pay 1000 RMB to cover their study period until graduation in November.

For more information, please visit

<https://www.nottingham.edu.cn/en/global/student-service/insurance.aspx>





# Accommodation



Students will live in an International Student Residence Hall on campus with other students from around the world where all the rooms are fully furnished. There are several options available for international students. All the single occupancy rooms in building 11 are air-conditioned and equipped with a telephone, broadband connection, a TV set and a separate bathroom. There are kitchen facilities on each floor where you can share your cooking skills with others. Accommodation in the building 18 and 20 takes the form of fully furnished, four-room flats. Each flat has four private bedrooms, two toilets, one shower room, one washing room and a lounge/common room. The fees are ranged from 11,000RMB to 16,000RMB per year (5,500RMB to 8,000RMB per semester). Further information on on-campus accommodation in UNNC is available at:

<https://www.nottingham.edu.cn/en/global/student-service/accommodation/index.aspx>

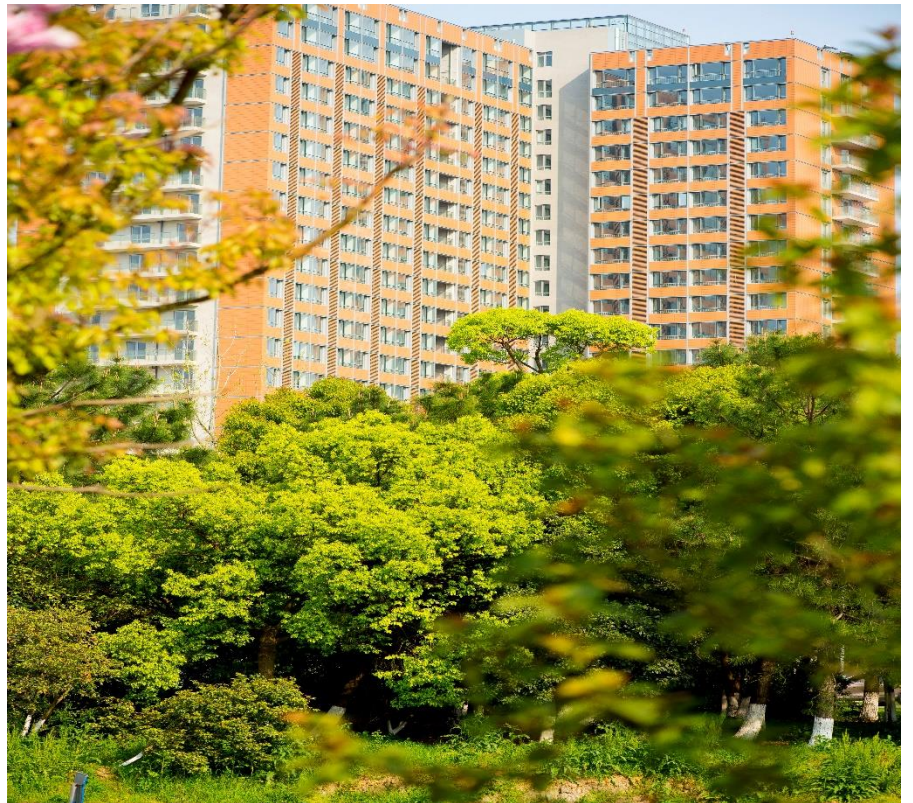



# Supporting Service



## Welcoming You to China

Arriving in a new country can be daunting. We therefore offer a free coach pick up service for new international students arriving at Shanghai Pudong Airport and Ningbo Airport during the induction period. We will also help you with the paper work required for visas, police registration, and will ensure there is an medical adviser to accompany you for mandatory health checks after you arrival in China.

## Orientation Programme

A comprehensive orientation program is provided before the start of each academic semester. This aimed specifically at helping international students settle in. We take care of practical details, like opening a bank account, and ensure there is a line-up of social activities so you can meet people and make new friends.

## International Student Support

Staff in Global Engagement Office and Campus Life are committed to offering guidance and support to international students from the moment you register. We can offer you expert advice on matters such as visa and immigration regulations, accommodation, life on campus and even what to pack.

## Student Counseling Service

This is a confidential service available to all students of the University, run by professionally qualified counselors, for a wide range of issues including anxiety, depression, family concerns and relationship issues.

## Student Disability Service

The Disability Service is the first point of contact for any student or potential student who has a disability that the University should be aware of. The service is completely confidential. A range of on course and assessment support is available once you register with the service.

## Health Service

The University has a clinic which provides a 24-hour health service to help students with medical or personal problems. There are English-speaking medical adviser and nurses whose focus are international students.

## Events and excursions

The Student Engagement Office runs a number of events and excursions for exchange students every semester. These include a series of festival events, company visits, as well as trips to places including traditional Chinese ancient town, Hangzhou, and other popular destinations in China.



# Location: Ningbo

Ningbo is located in Zhejiang province on the south shore of Hangzhou Bay, opposite Shanghai. 7,000 years old, populated with more than six million people and covering more than 1,000 square kilometres, Ningbo is a rapidly growing city. Ranked in the top ten of cities for business in China by Forbes, it is a thriving blend of enterprise, culture, education, tradition and entertainment.

Ningbo offers the opportunity to feel at home amongst an array of international shopping outlets, restaurants, theatres, cinemas, clubs and bars, whilst hosting international sports and music events. It also provides the chance to embrace culture and tradition. Unique temples and intricate streets house an array of markets boasting a variety of antiques, textiles and delicious Ningbo cuisine. National and local festivities flaunt the delights of Chinese culture whilst close to one hundred museums and exhibitions represent the city's historic past and innovative future.

Home to the second largest port in the world, Ningbo's import and export industry is one of the most important to the city and its businesses. The city is a unique mix of modern sky-scrapers and traditional architecture, complimented with stunning parkland and scenic spots, making it a place for all.

The city's excellent transport links mean that Ningbo is an ideal location to explore and one from which to open up the vast delights that both China and Asia have to offer.





# Contact

Name	Title	Region	Contact
Kevin Lin	Director of Global Relations	CEEC	Tel: (+86) (0) 574 88180000 (8121) Email: kevin.lin@nottingham.edu.cn
Jacqueline Lin	Senior Manager for GEO Initiatives and Planning	China and Africa	Tel: (+86) (0) 574 88180000 (8112) Email: jacqueline.lin@nottingham.edu.cn
Rebecca Huang	HMT Affairs Manager	HMT and Asia	Tel: (+86) (0) 574 88180000 (8257) Email: rebecca.huang@nottingham.edu.cn
Catherine Zhang	Exchange Programme Manager	Europe	Tel: (+86) (0) 574 88180000 (8005) Email: catherine.zhang@nottingham.edu.cn
Kris Mao	Study Abroad Manager	Canada and America	Tel: (+86) (0) 574 88180000 (2732) Email: kris.mao@nottingham.edu.cn
Freya Song	International Affairs Manager	Australia and New Zealand	Tel: (+86) (0) 574 88180000 (2272) Email: freya.song@nottingham.edu.cn
Tamara Tan	Global Engagement Development Manager	UK and Inter-campus	Tel: (+86) (0) 574 88180000 (8442) Email: tamara.tan@nottingham.edu.cn
Amy Shi	Assistant		Tel: (+86) (0) 574 88180000 (7601) Email: amy.shi@nottingham.edu.cn

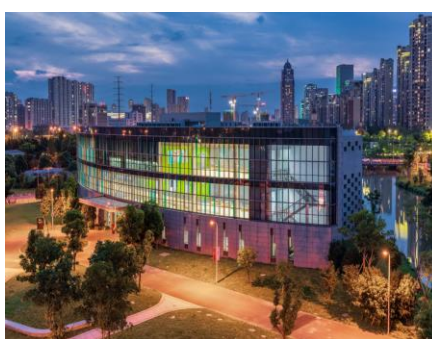

## Useful Links

Global Engagement office:

<https://www.nottingham.edu.cn/en/global/index.aspx>

Accommodation:

<https://www.nottingham.edu.cn/en/global/student-service/accommodation/index.aspx>

Academic Calendar:

<https://www.nottingham.edu.cn/en/about/key-dates/home.aspx>

Courses:

<http://www.nottingham.edu.cn/en/faculties/index.aspx>

<http://modulecatalogue.nottingham.ac.uk/ningbo>